

Beginning at Maple at foot of Island
Thence N 57° E 36 rods & tenths of a rod
" N 40° E 3 rods to line agreed
upon by Josiah Hall & A.H. Ludlow

- 1. N. 43. E. 24 Perches
- 2. N. 0 E. 10 "
- 3. N. 78 W. 10 "
- 4. S. 78 W. 20.5 "
- 5. S. 28. W. 15.6 "
- 6. S. 62. E. 9. "
- 7. N. 72 E. 20.5 "
- 8. S. 38 W. 15. "

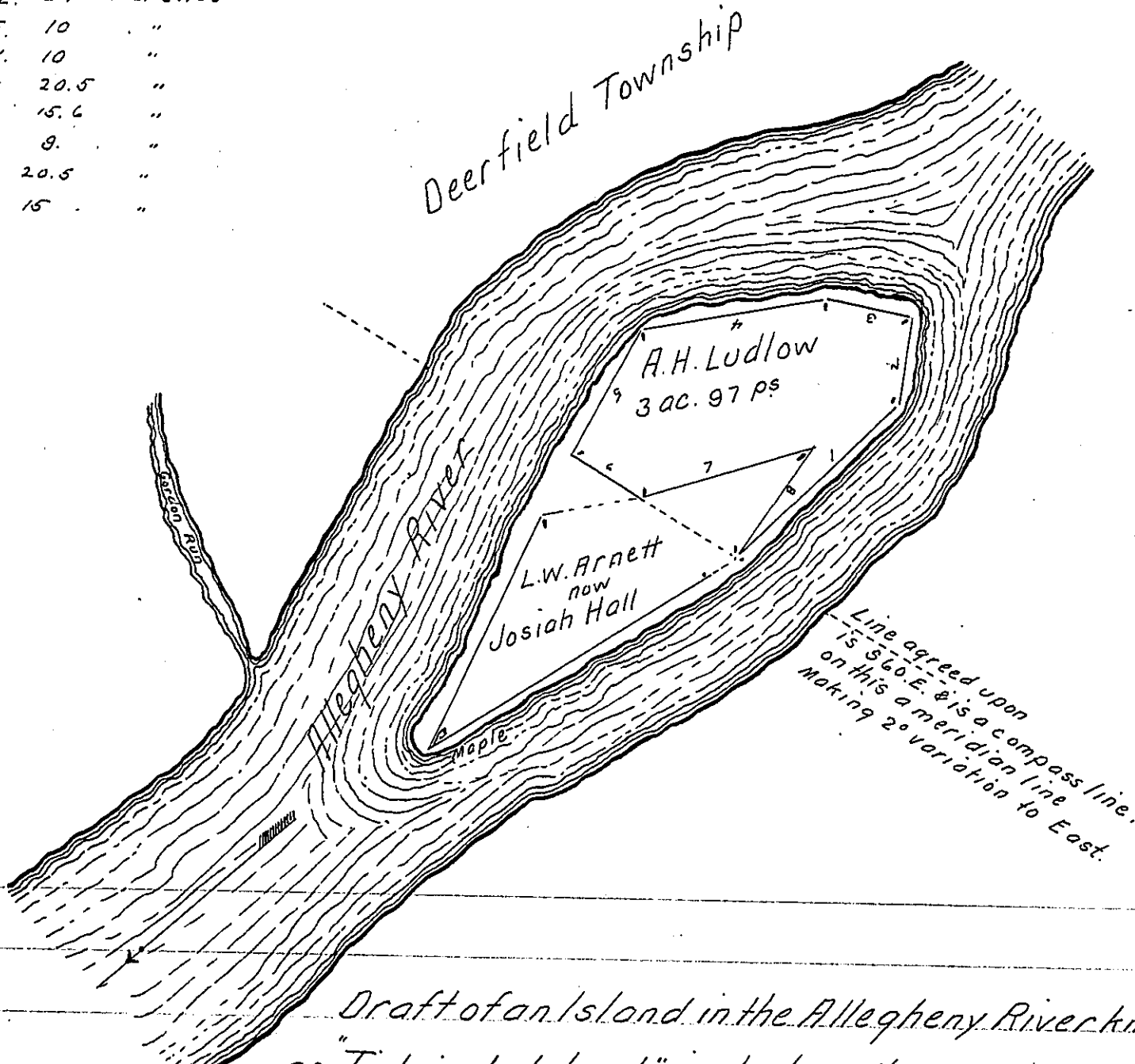

Draft of an Island in the Allegheny River known
as "Tideoute Island" just above the mouth of Gordon
Run in Deerfield Township Warren County. Containing Three acres
& ninety seven perches. Surveyed for A.H. Ludlow in pursuance of
a Warrant granted to him dated the 24th day of January A.D. 1860.
And in accordance with an agreement between Josiah Hall and
A.H. Ludlow. dated 23^d day of July A.D. 1860.
Witness my hand the 7th day of September A.D. 1860.

P. Falconer
C.S.

IN TESTIMONY that the above is a copy of the original remaining on file in
the Department of Internal Affairs of Pennsylvania, made
conformably to an Act of Assembly approved the 16th day of
February, 1833, I have hereunto set my Hand and caused
the Seal of said Department to be affixed at Harrisburg,
this seventh day of September 1905,

James P. [Signature]
Secretary of Internal Affairs.